

## Motor Pigtail Connectors

Quick, reliable change-out of electric motors with no bolting, taping or loose connections.

### Motor Lead Disconnects

- Complete line of motor lead disconnects for 600V and 5kV applications, covering wire range from #16 AWG through 500 kcmil
- Fast, snap-together assembly offers maximum labor savings
- No need for nuts, bolts and washers or insulating tape — simply slide on reusable boot
- Total assembly fits into tight motor housings
- Quick disconnect — no knife cutting of melted tape, eliminating the risk of accidental cutting of wire insulation, resulting motor downtime and installer exposure
- Meet or exceed electrical and mechanical performance of bolted connections
- Constructed of high-conductivity copper with tin plating
- Female disconnects equipped with beryllium copper interface band for dependable connections

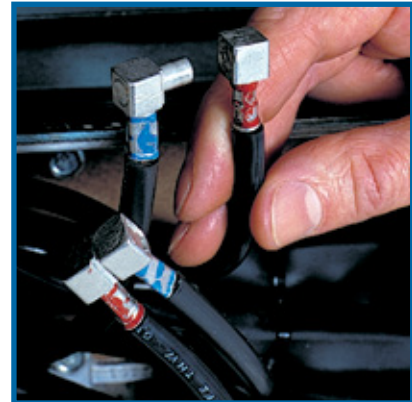

### Motor Pigtail Connector — One Line to One Load (2 Wire)

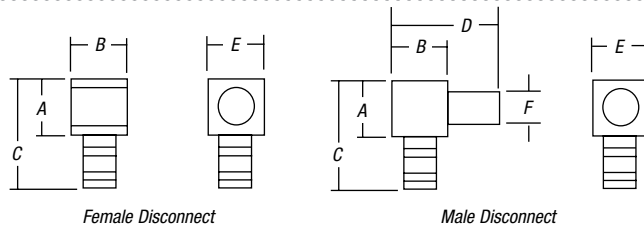

CAT. NO.		WIRE SIZE	BODY SIZE	COLOR CODE	BOOT INSULATION	DIMENSIONS (IN.)						STRIP LENGTH (IN.)
FEMALE DISCONNECT	MALE DISCONNECT					A	B	C	D	E	F	
MD1614F-0	MD1614M-0	#16-#14 AWG	0	BLUE	MDBOOT-0	.25	.25	.63	.52	.25	.125	3/64
MD1614F-1	MD1614M-1	#16-#14 AWG	1	BLUE	MDBOOT-1	.38	.38	.78	.75	.38	.250	3/8
MD1210F-1	MD1210M-1	#12-#10 AWG	1	YELLOW	MDBOOT-1	.38	.38	.78	.75	.38	.250	3/8
MD1210F-2	MD1210M-2	#12-#10 AWG	2	YELLOW	MDBOOT-2	.50	.50	.90	1.00	.50	.370	3/8
MD8F-1	MD8M-1	#8 AWG	1	RED	MDBOOT-1	.38	.38	.82	.75	.38	.250	7/16
MD8F-2	MD8M-2	#8 AWG	2	RED	MDBOOT-2	.50	.50	.95	1.00	.50	.370	7/16
MD6F-1	MD6M-1	#6 AWG	1	BLUE	MDBOOT-1	.38	.38	.88	.75	.38	.250	1/2
MD6F-2	MD6M-2	#6 AWG	2	BLUE	MDBOOT-2	.50	.50	1.02	1.00	.50	.370	1/2
MD4F-2	MD4M-2	#4 AWG	2	GRAY	MDBOOT-2	.50	.50	1.06	1.00	.50	.370	1/2
MD2F-2	MD2M-2	#2 AWG	2	BROWN	MDBOOT-2	.50	.50	1.09	1.00	.50	.370	17/32
MD2F-3	MD2M-3	#2 AWG	3	BROWN	MDBOOT-3	.88	.88	1.46	1.75	.88	.500	17/32
MD1F-2	MD1M-2	#1 AWG	2	GREEN	MDBOOT-2	.50	.50	1.23	1.00	.50	.370	9/16
MD1F-3	MD1M-3	#1 AWG	3	GREEN	MDBOOT-3	.88	.88	1.56	1.75	.88	.500	9/16
MD10F-3	MD10M-3	1/0 AWG	3	PINK	MDBOOT-3	.88	.88	1.56	1.75	.88	.500	9/16
MD20F-3	MD20M-3	2/0 AWG	3	BLACK	MDBOOT-3	.88	.88	1.59	1.75	.88	.500	5/8
MD30F-3	MD30M-3	3/0 AWG	3	ORANGE	MDBOOT-3	.88	.88	1.71	1.75	.88	.500	11/16
MD40F-3	MD40M-3	4/0 AWG	3	PURPLE	MDBOOT-3	.88	.88	1.81	1.75	.88	.500	3/4
MD40F-4	MD40M-4	4/0 AWG	4	PURPLE	MDBOOT-4	1.25	1.25	2.89	2.69	1.25	.813	—
MD250F-4	MD250M-4	250 kcmil	4	YELLOW	MDBOOT-4	1.25	1.25	2.89	2.69	1.25	.813	—
MD350F-4	MD350M-4	350 kcmil	4	RED	MDBOOT-4	1.25	1.25	2.89	2.69	1.25	.813	—
MD500F-4	MD500M-4	500 kcmil	4	BROWN	MDBOOT-4	1.25	1.25	2.89	2.69	1.25	.813	—

Tooling: pp. F-80-F-100

Die Selector Chart: pp. F-101-F-104

## Motor Pigtail Connectors

Quick, easy installation!

### Motor Pigtail Connector — One Line to One Load (2 Wire) (continued)

- 1 Choose appropriate Blackburn® disconnect for conductor size to be terminated. Note color of bands on disconnect barrel.
- 2 Select proper installing die by matching die color to disconnect barrel color bands.
- 3 Install die in T&B tool, insert stripped wire into barrel of disconnect and compress between color bands. Repeat for mating half.
- 4 Snap the two halves together and slip on insulator over mated connection. Secure insulator with Ty-Rap® cable ties provided with the insulators.

**Material:** High-Conductivity Copper

**Plating:** Tin

**Insulator:** Thermoplastic Elastomer



600V Version



5kV Version



#### INSTALLING TOOLS

CAT. NO.		WT112M WT111M WT2000 ERG4002	TBM45S	TBM6, TBM6S		TBM5 TBM5S	TBM8 TBM8S	HYDRAULIC TOOLS	
FEMALE DISCONNECT	MALE DISCONNECT			UPPER DIE	LOWER DIE	DIE SET	DIE SET	DIE CODE	COLOR
MD1614F-0	MD1614M-0	BLUE	—	—	—	—	—	—	—
MD1614F-1	MD1614M-1	—	—	—	—	—	—	—	—
MD1210F-1	MD1210M-1	YELLOW	—	—	—	—	—	—	—
MD1210F-2	MD1210M-2	—	—	—	—	—	—	—	—
MD8F-1	MD8M-1	—	X	13475	13477	13454	13461	21	RED
MD8F-2	MD8M-2	—	X	13475	13477	13454	13461	21	RED
MD6F-1	MD6M-1	—	X	13475	13477	13454	13461	24	BLUE
MD6F-2	MD6M-2	—	X	13475	13477	13454	13461	24	BLUE
MD4F-2	MD4M-2	—	X	13472	13476	13454	13461	29	GRAY
MD2F-2	MD2M-2	—	X	13474	13477	13454	13461	33	BROWN
MD2F-3	MD2M-3	—	X	13474	13477	13454	13461	33	BROWN
MD1F-2	MD1M-2	—	—	13474	13477	13455	13462	37	GREEN
MD1F-3	MD1M-3	—	—	13474	13477	13455	13462	37	GREEN
MD10F-3	MD10M-3	—	—	13475	13477	13455	13462	42	PINK
MD20F-3	MD20M-3	—	—	13474	13477	13455	13462	45	BLACK
MD30F-3	MD30M-3	—	—	13474	13477	13455	13462	50	ORANGE
MD40F-3	MD40M-3	—	—	13475	13477	13456	13463	54	PURPLE
MD40F-4	MD40M-4	—	—	13475	13477	13456	13463	54	PURPLE
MD250F-4	MD250M-4	—	—	13473	13476	13456	13463	62	YELLOW
MD350F-4	MD350M-4	—	—	13472	13476	13458	13466	71H	RED
MD500F-4	MD500M-4	—	—	13478	13478	13458	13468	87H	BROWN

**Specifications:** Wire Range: #16 to 4/0 AWG

Rating: 600V, 90° C

Tooling: pp. F-80-F-100

Die Selector Chart: pp. F-101-F-104

## Motor Pigtail Connectors

### Motor Pigtail Connector — One Line to Two Load (3 Wire)

- KON-TOUR™ louvered contact bands
- Color coded to match installing dies

**Material:** High-Conductivity Wrought Copper  
**Finish:** Electro-Tin Plate

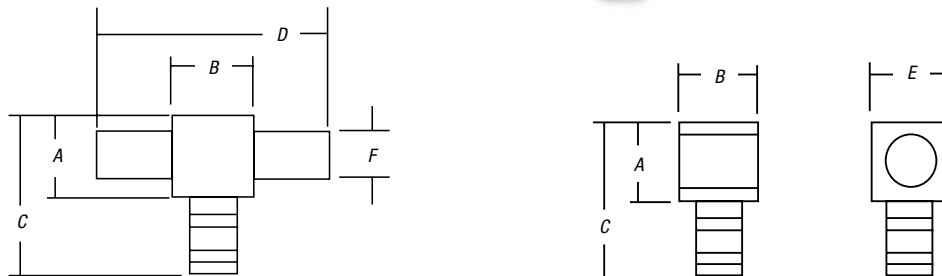

CAT. NO.		WIRE SIZE	BODY SIZE	COLOR CODE	BOOT INSULATION	DIMENSIONS (IN.)						STRIP LENGTH (IN.)
FEMALE DISCONNECT	MALE DISCONNECT					A	B	C	D	E	F	
MD1614F-0	M2D1614M-0	#16-#14 AWG	0	BLUE	MDBOOT-1	.250	.250	.63	.77	.25	.12	3/8
MD1210F-1	M2D1210M-1	#12-#10 AWG	1	YELLOW	M2DBOOT-1	.380	.380	.780	.750	.380	.25	3/8
MD1210F-2	M2D1210M-2	#12-#10 AWG	2	YELLOW	M2DBOOT-2	.500	.500	.900	1.500	.500	.37	3/8
MD8F-1	M2D8M-1	#8 AWG	1	RED	M2DBOOT-1	.380	.380	.820	1.125	.380	.25	7/16
MD8F-2	M2D8M-2	#8 AWG	2	RED	M2DBOOT-2	.500	.500	.950	1.500	.500	.37	7/16
MD6F-1	M2D6M-1	#6 AWG	1	BLUE	M2DBOOT-1	.380	.380	.875	1.125	.380	.25	1/2
MD6F-2	M2D6M-2	#6 AWG	2	BLUE	M2DBOOT-2	.500	.500	1.020	1.500	.500	.37	1/2
MD4F-2	M2D4M-2	#4 AWG	2	GRAY	M2DBOOT-2	.500	.500	1.060	1.500	.500	.37	1/2
MD2F-2	M2D2M-2	#2 AWG	2	BROWN	M2DBOOT-2	.500	.500	1.090	1.500	.500	.37	17/32
MD2F-3	M2D2M-3	#2 AWG	3	BROWN	M2DBOOT-3	.875	.875	1.460	2.630	.875	.50	17/32
MD1F-2	M2D1M-2	#1 AWG	2	GREEN	M2DBOOT-2	.50	.50	1.230	1.500	.500	.37	9/16
MD1F-3	M2D1M-3	#1 AWG	3	GREEN	M2DBOOT-3	.875	.875	1.560	2.630	.875	.50	9/16
MD10F-3	M2D10M-3	1/0 AWG	3	PINK	M2DBOOT-3	.875	.875	1.560	2.630	.875	.50	9/16
MD20F-3	M2D20M-3	2/0 AWG	3	BLACK	M2DBOOT-3	.875	.875	1.590	2.630	.875	.50	5/8
MD30F-3	M2D30M-3	3/0 AWG	3	ORANGE	M2DBOOT-3	.875	.875	1.710	2.630	.875	.50	11/16
MD40F-3	M2D40M-3	4/0 AWG	3	PURPLE	M2DBOOT-3	.875	.875	1.810	2.630	.875	.50	3/4

Operating Range: 600V max., 1000V max. in signs and fixtures.

Listing: UL® Listed and CSA Certified for #12-#8 AWG solid copper conductors and stranded copper conductors in the sizes shown.

Selection: Always use the same body size when selecting male and female disconnects. For example, to connect a #2 AWG male to a #8 AWG female, select Catalog Numbers M2D2M-2 and MD8F-2. Both have body size 2.

Insulation: Use insulating boots matching the disconnect body size as indicated in the chart. To protect the connection from moisture and dirt, use sealing compound (Catalog Number MDBOOT-SEAL).

Tooling: pp. F-80-F-100

Die Selector Chart: pp. F-101-F-104

## Motor Pigtail Connectors

### Motor Pigtail Connector — One Line to Two Load (3 Wire) (continued)

- KON-TOUR™ louvered contact bands
- Color coded to match installing dies

**Material:** High-Conductivity Wrought Copper

**Finish:** Electro-Tin Plate

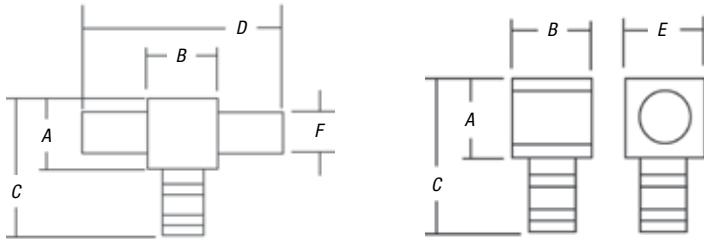
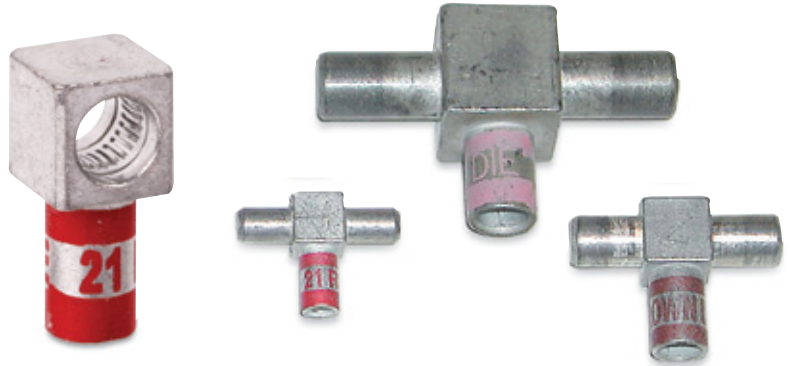

CAT.NO.		INSTALLING TOOLS							
FEMALE DISCONNECT	MALE DISCONNECT	WT112M WT111M ERG4002 WT2000	TBM6 TBM6S			TBM5 TBM5S	TBM8 TBM8S	HYDRAULIC TOOLS	
			TBM25S	UPPER DIE	LOWER DIE	DIE SET	DIE SET	DIE CODE	COLOR
MD1614F-0	M2D1614M-0	BLUE	—	—	—	—	—	—	—
MD1210F-1	M2D1210M-1		—	—	—	—	—	—	—
MD1210F-2	M2D1210M-2		—	—	—	—	—	—	—
MD8F-1	M2D8M-1	YELLOW	X	13475	13477	13454	13461	21	RED
MD8F-2	M2D8M-2		—	X	13475	13477	13454	13461	21
MD6F-1	M2D6M-1	—	X	13475	13477	13454	13461	24	BLUE
MD6F-2	M2D6M-2	—	X	13475	13477	13454	13461	24	BLUE
MD4F-2	M2D4M-2	—	X	13472	13476	13454	13461	29	GRAY
MD2F-2	M2D2M-2	—	X	13474	13477	13454	13461	33	BROWN
MD2F-3	M2D2M-3	—	X	13474	13477	13454	13461	33	BROWN
MD1F-2	M2D1M-2	—	—	13474	13477	13455	13462	37	GREEN
MD1F-3	M2D1M-3	—	—	13474	13477	13455	13462	37	GREEN
MD10F-3	M2D10M-3	—	—	13475	13477	13455	13462	42	PINK
MD20F-3	M2D20M-3	—	—	13474	13477	13455	13462	45	PINK
MD30F-3	M2D30M-3	—	—	13474	13477	13455	13462	50	ORANGE
MD40F-3	M2D40M-3	—	—	13475	13477	13456	13463	54	PURPLE

Tooling: pp. F-80-F-100

Die Selector Chart: pp. F-101-F-104